

DEVELOPMENT PARAMETERS OF THE APPLICATION SITE

APPLICATION SITE AREA : 1,209m² (ABOUT)
 COVERED AREA : 435.5m² (ABOUT)
 UNCOVERED AREA : 773.5m² (ABOUT)

PLOT RATIO : 0.4 (ABOUT)
 SITE COVERAGE : 36% (ABOUT)

NO. OF STRUCTURE : 6
 DOMESTIC GFA : NOT APPLICABLE
 NON-DOMESTIC GFA : 511.5m² (ABOUT)
 BUILDING HEIGHT : 3m - 7.2m (ABOUT)
 NO. OF STOREY : 1 - 2

STRUCTURE	USE	COVERED AREA	GFA	BUILDING HEIGHT
B1	SHOP AND SERVICES	173.5m ² (ABOUT)	173.5m ² (ABOUT)	7.2m (ABOUT)(1-STOREY)
B2	SHOP AND SERVICES (G/F) & SITE OFFICE (1/F)	61m ² (ABOUT)	122m ² (ABOUT)	7.2m (ABOUT)(2-STOREY)
B3	SHOP AND SERVICES	151m ² (ABOUT)	151m ² (ABOUT)	5.5m (ABOUT)(1-STOREY)
B4	TOILET (G/F) & STORAGE OF GOODS (1/F)	15m ² (ABOUT)	30m ² (ABOUT)	6m (ABOUT)(2-STOREY)
B5	STORAGE OF GOODS	30m ² (ABOUT)	30m ² (ABOUT)	3m (ABOUT)(1-STOREY)
B6	FIRE SERVICE WATER TANK AND CONTROL PANEL	5m ² (ABOUT)	5m ² (ABOUT)	3m (ABOUT)(1-STOREY)
TOTAL		435.5m² (ABOUT)	511.5m² (ABOUT)	

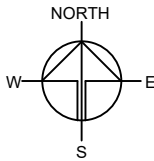

HOSE REEL
 COVERAGE TO
 ALL STRUCTURE
 30M (RADIUS)

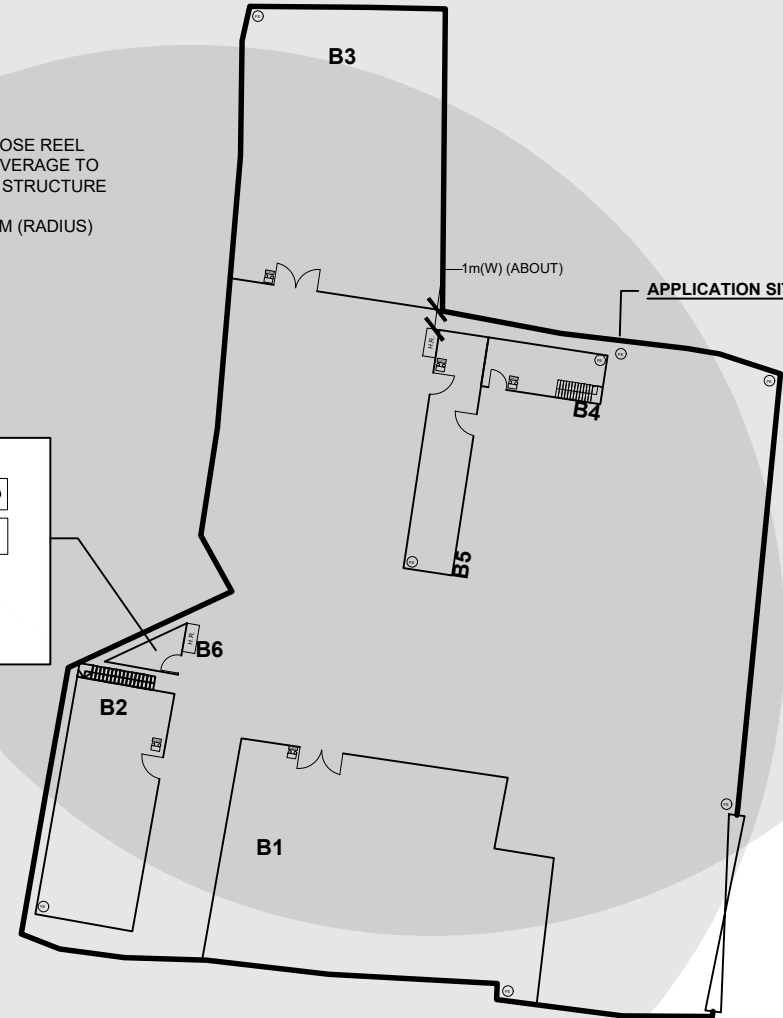

FIRE SERVICE INSTALLATIONS

- EXIT SIGN
- VISUAL FIRE ALARM
- FIRE ALARM BELL
- MANUAL FIRE ALARM CALL POINT
- EMERGENCY LIGHTING
- SAND BUCKET
- 5KG WATER TYPE FIRE EXTINGUISHER
- 2m³ FS WATER TANK
- FIRE ALARM / HOSE REEL PUMP CONTROL PANEL
- FS HOSE REEL
- FS HOSE REEL PUMP WITH ENCLOSURE

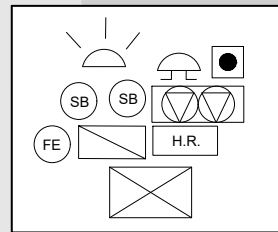

FS NOTES

- SUFFICIENT EMERGENCY LIGHTING SHALL BE PROVIDED THROUGHOUT THE ENTIRE BUILDING IN ACCORDANCE WITH BS5266: PART1 AND BS EN1838
- SUFFICIENT DIRECTIONAL AND EXIT SIGN SHALL BE PROVIDED IN ACCORDANCE WITH BS5266: PART 1 AND FSD CIRCULAR LETTER 5/2008.
- FIRE ALARM SYSTEM PROVIDED THROUGHOUT THE ENTIRE BUILDING IN ACCORDANCE WITH BS+5839-1:2002A 2:2008 AND FSD CIRCULAR LETTER. 1/2009 ONE ACTUATION POINT SHOULD INCLUDE FACILITIES FOR FIRE PUMP START AND AUDIO /VISUAL WARNING DEVICE INITIATION.
- A MODIFIED HOSE REEL SYSTEM SUPPLIED BY 2M3 FS WATER TANK SHALL BE PROVIDED. THERE SHALL BE SUFFICIENT HOSE REELS TO ENSURE THAT EVERY PART OF EACH BUILDING CAN BE REACH BY A LENGTH OF NOT MORE THAN 30M OF HOSE REEL TUBING.
- POTABLE HAND-OPERATED APPROVED APPLICATION SHALL BE PROVIDED AS REQUIRED BY OCCUPANCY.
- WHERE AN ELECTRICAL INSTALLATION IS REQUIRED TO COMPLY WITH THIS CODE, A PRIMARY AND SECONDARY SOURCE OF SUPPLY SHALL BE PROVIDED TO THE SATISFACTION OF THE DIRECTOR OF FIRE SERVICES AND ALL SUCH INSTALLATIONS SHALL BE FED FROM BOTH THE PRIMARY AND SECONDARY SOURCE OF SUPPLY.

LEGEND

- APPLICATION SITE
- ENCLOSED STRUCTURE
- CANOPY
- PARKING SPACE
- INGRESS / EGRESS

Drawing No. APPENDIX I Ver. 01

Project
 TEMPORARY SHOP AND SERVICES FOR A PERIOD OF 5 YEARS

VARIOUS LOTS IN D.D. 104 AND ADJOINING GOVERNMENT LAND, CASTLE PEAK ROAD - MAI PO, MAI PO, YUEN LONG, NEW TERRITORIES

Drawing Title
 FSIs PROPOSAL (1/2)

Scale of A4
 1 : 400

Drawn Date
 OL 25.3.2021

Revised Date
 OL 08.2.2022

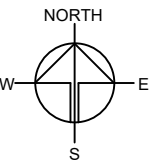

INTERNAL LAYOUT OF STRUCTURE 1/F

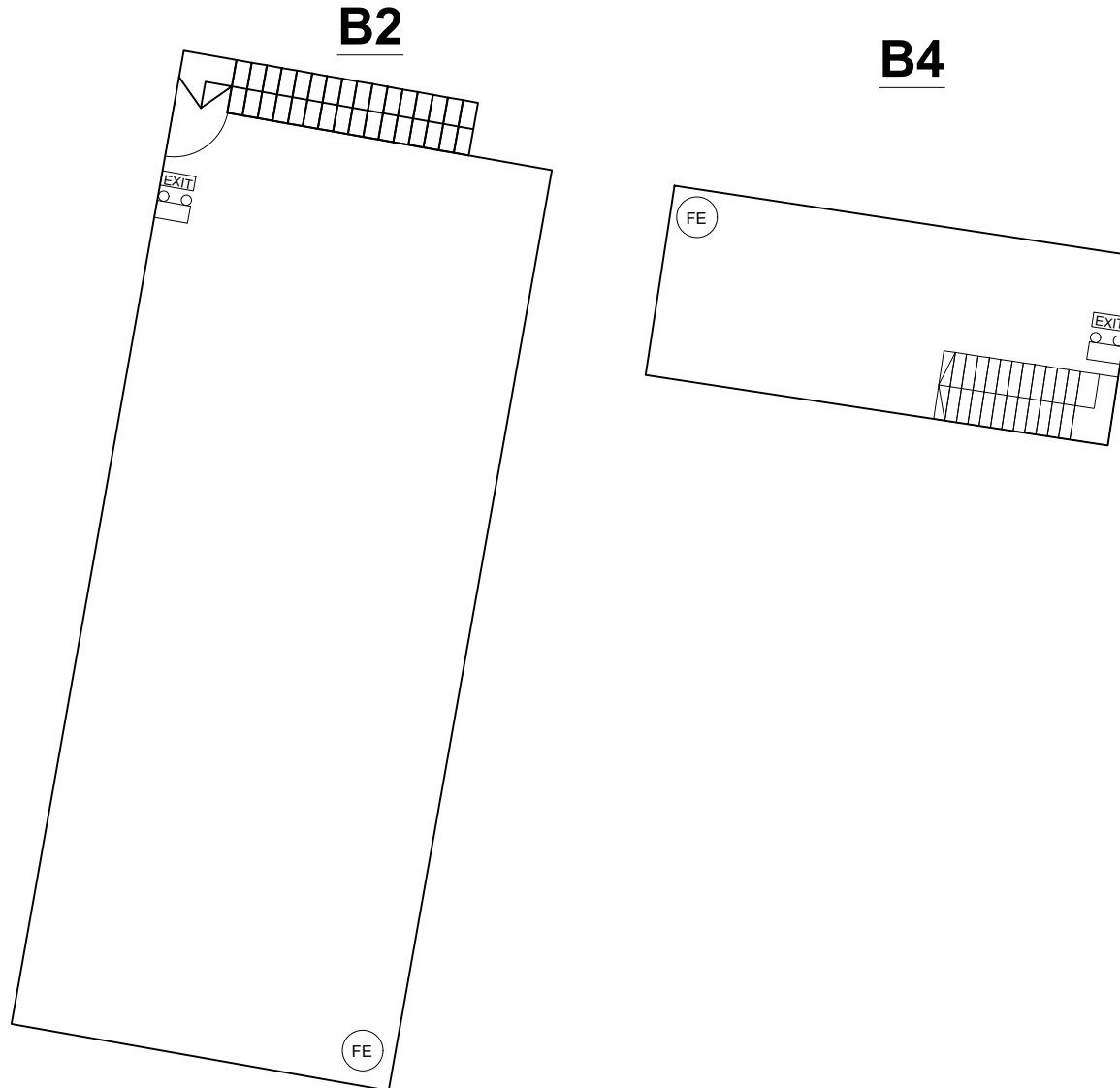

Drawing No.	APPENDIX I	Ver.	01
Project	TEMPORARY SHOP AND SERVICES FOR A PERIOD OF 5 YEARS		
Drawing Title	VARIOUS LOTS IN D.D. 104 AND ADJOINING GOVERNMENT LAND, CASTLE PEAK ROAD - MAI PO, MAI PO, YUEN LONG, NEW TERRITORIES		
Scale of A4	1 : 400		
Drawn	OL	Date	25.3.2021
Revised	OL	Date	08.2.2022